

RECOMMENDED PCB LAYOUT
GENERAL TOLERANCE ±0.05

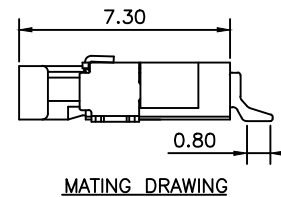
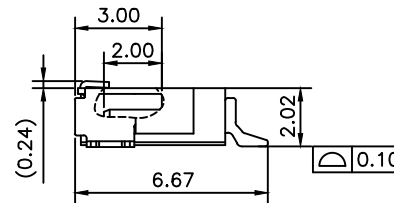

MATING DRAWING

NOTES:

- MATERIAL:
 - HOUSING: THERMOPLASTIC, HIGH TEMP, UL94V-0; COLOR: BLACK;LCP
 - CONTACT: COPPER ALLOY(BRASS)
 - SHELL: COPPER ALLOY(NICKEL SLIVER)
- FINISH:

CONTACT:

 - 50~100u" NICKEL UNDERPLATING OVERALL.
 - CONTACT POINT: GOLD 3u"MIN
SOLDER TAIL: GOLD 1u" MIN
 - CONTACT POINT: GOLD 5u"MIN
SOLDER TAIL: GOLD 1u" MIN
 - CONTACT POINT: GOLD 10u"MIN
SOLDER TAIL: GOLD 1u" MIN
- REFLOW SOLDER CAPABLE TO 260°C PER ACES SPEC.
- SPEC. PLS. REFER TO SPEC-50458-XXXXX-XXX
- PACKAGE PLS. REFER TO 50458-XXXXX-XX-TRP& 50458-XXXXX-U-TRP
- PART NUMBER

50458-XXX X X-XXX

NO OF CKT	TYPE	PACKING	SHELL
0	001	50458-XXXXCR	SMT TYPE, PLS SEE PAGE 1
1	003	50458-XXXXCR-U	SMT TYPE, PLS SEE PAGE 1
	Q01	50458-XXXXCR-01	SMT TYPE, PLS SEE PAGE 1
	AT2	50458-XXXXCR-U	SMT TYPE, PLS SEE PAGE 1

PACKING
0: TAPE & REEL
1: Tube

PLATING

- GOLD FLASH
- CONTACT POINT: GOLD 5u"MIN
SOLDER TAIL: GOLD 1u" MIN
- CONTACT POINT: GOLD 10u"MIN
SOLDER TAIL: GOLD 1u" MIN

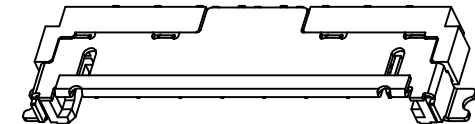

CKTS	DIMA	DIMB	DIMC	DIMD	DIME
006	10	10.00	17.2	12.2	15.7
007	12	12.00	19.2	14.2	17.7
008	14	14.00	21.2	16.2	19.7
009	16	16.00	23.2	18.2	21.7
010	18	18.00	25.2	20.2	23.7

QUALITY SYMBOLS MAJOR (M) CRITICAL (C)	DRAWN BY Huailin	DATE 21/09/02	ACES ELECTRONICS	
	CHECKED BY BRAVE	DATE 21/09/02		
GENERAL TOLERANCES (UNLESS SPECIFIED) X. ±0.5 .X ±0.25 .XX ±0.15 .XXX ±0.1 ANGLES ±2°	APPROVED BY BRAVE	DATE 21/09/02	TITLE 2.0MM WTB WAFER CONN.SMT R/A TYPE	
	UNITS mm	SHEET NO. 1 OF 2	SCALE 1:1	SIZE A4
			REV H	PART NO. SEE NOTES